

SCREW ANCHORING PRICE BOOK

2019



DIGGA NORTH AMERICA

2325 INDUSTRIAL PARKWAY SW
DYERSVILLE, IA 52040
USA

PH: 563 875 7915
CELL: 563 845 9177

EMAIL: INFO@DIGGAUSA.COM
WEB: WWW.DIGGAUSA.COM

DIGGA GROUP TERMS AND CONDITIONS

1. TERMS AND CONDITIONS

The supply of all Goods by DIGGA GROUP herein after be referred to as the Supplier, shall be subject to these Terms and Conditions whether in the past, present or in the future. These Terms and Conditions shall prevail over any other terms and conditions including those implied by Statute to the extent permissible at Law. The applicant acknowledges having read the Terms and Conditions of Sale prior to signing the Application for Credit Account.

2. INVOICE

Goods are invoiced at the time of dispatch.

3. CREDIT APPROVAL

All orders or shipping instructions will be subject to approval by DIGGA prior to shipment. Copies of current Dealer or Distributor financial statements are required annually, and signed Security Agreements and UCC-1's must be on file where applicable. The Supplier reserves the right to withdraw credit and supply.

4. RETENTION OF TITLE

- A) Until the goods, the subject of the contract, are paid in full.
- B) Ownership shall remain with the supplier but the risk shall pass to the Applicant.
- C) The relationship between the parties shall be fiduciary and the applicant shall hold the goods as bailee for the Supplier.
- D) The Supplier authorizes the Applicant to on sell the goods but as agent for the Supplier. The Applicant shall however, not represent to any parties that it is in any way acting for the Suppliers and the Suppliers will not be bound by any contracts with third parties to which the Applicant is a party.
- E) In the event that the Applicant defaults or commits an act of bankruptcy or a receiver is appointed or the company goes into liquidation without prejudice to any other rights the vendor may have, the Applicant by receiving delivery of the goods authorizes the Supplier to retake possession of any unpaid for goods and resell same without accounting to the applicant therefore.

5. DEFAULTS

If the Applicant defaults in paying any amount owed by the Applicant to the supplier under the terms and conditions of sale, then any amount invoiced to or owned by the Applicant to the Supplier becomes immediately payable and the Applicant agrees to indemnify the Supplier against all costs (including solicitor and own client costs, commercial agent commissions, freight, insurance, loss of profit and interest) incurred by the Supplier as a result of the Applicant's default.

7. PAYMENT

The Supplier may at its sole and absolute discretion appropriate any payment received from the Applicant against whatever amount is owing by the Applicant to the Supplier under the terms and conditions of sales as are due.

8. RIGHT TO REFUSE SUPPLY

The Supplier reserves the right to accept or decline in whole or in part any order made by the Applicant for the supply of goods and to supply the goods ordered in whole or in part.

9. DELIVERY

- A) Notwithstanding that an approximate date stipulated in the order for delivery of the goods, the time for delivery of the goods shall not be regarded as of the essence.
- B) Subject to the Clause, the Supplier shall make all reasonable and commercial efforts to have the goods delivered to the Applicant on the day agreed between the parties but the Supplier, its agents and servants shall be under no liability what so ever, nor shall the Applicant be entitled to treat the contract as repudiated should delivery not be made at that time.

9. RIGHT TO REFUSE SUPPLY

The Supplier reserves the right to accept or decline in whole or in part any order made by the Applicant for the supply of goods and to supply the goods ordered in whole or in part.

10. DELIVERY

- A) Notwithstanding that an approximate date stipulated in the order for delivery of the goods, the time for delivery of the goods shall not be regarded as of the essence.
- B) Subject to the Clause, the Supplier shall make all reasonable and commercial efforts to have the goods delivered to the Applicant on the day agreed between the parties but the Supplier, its agents and servants shall be under no liability what so ever, nor shall the Applicant be entitled to treat the contract as repudiated should delivery not be made at that time.

11. RECEIPT

Under no circumstances may the Applicant deny signature evidencing receipt of the goods by it of any employee, agent or carrier utilised or employed by the Applicant as the cause may be.

12. LIABILITY FOR DAMAGES AND WARRANTIES

- A) The customer and the Supplier agree that the Supplier accepts no responsibility or liability what so ever or how so ever arising whether in contract or tort or otherwise for loss of profit, business or savings or for any indirect or consequential loss of any nature arising out of or from the use, custody, supply or purchase of the goods to the fullest extent permitted by law and the Applicant forever discharges the Supplier from all such responsibilities and liability, claims, demands or actions in respect thereof.
- B) Where the Supplier becomes liable to the Applicant in any manner for any breach of any condition or warranty expressed or implied in relation to the supply of goods then the Supplier's liability will be limited, at the Supplier's sole and absolute discretion to either;
 - a) The replacement of the goods or
 - b) The supply of equivalent goods or
 - c) The price paid to the Applicant for the goods or
 - d) The cost of repair to the goods or
 - e) The cost of the resupply of the goods

13. CREDIT CARD TRANSACTIONS

As of the date of this publication all American Express credit card transactions will incur a 4% processing fee. Visa, Mastercard or DeKIT cards will incur a 2% processing fee.

14. CONDITIONS OF RETURNS

ALL RETURNS SUBJECT TO 15% RESTOCKING FEE.

Claims not accepted unless arrival is effected at the above address within 14 days, all freight and charges being prepaid.

SPECIALY MANUFACTURED OR OFF STANDARD PRODUCTS ARE NOT RETURNABLE AND WILL NOT BE ACCEPTED FOR CREDIT.

Acceptance of these goods is an acceptance of the foregoing conditions.

CONTENTS

<u>ANCHOR DRIVES-QUICK GUIDE</u>	3
<u>ANCHOR DRIVES-REFERENCE CHART</u>	4
<u>HANDHELD ANCHOR DRIVES</u>	4
<u>MINI LOADER AND EXCAVATOR UP TO 3.5T</u>	4
<u>ANCHOR DRIVES - SINGLE SPEED - 5,000-30,000 LBS/FT</u>	5
<u>ANCHOR DRIVES - TWO SPEED - 5,000-30,000 LBS/FT</u>	6
<u>LARGE ANCHOR DRIVES - TWO SPEED - 30,000-360,000 LBS/FT</u>	7-8
<u>MACHINE MOUNTS</u>	8-9
<u>HOSE KITS AND CASE DRAIN KITS</u>	10
<u>ANCHOR DRIVE ACCESSORIES</u>	10
<u>TORQUE MEASUREMENT SYSTEMS</u>	11
<u>WARRANTY</u>	12

ANCHOR DRIVES - QUICK GUIDE

Digga Anchor Drives are fitted with an integrated pressure relief valve & ECV (Energy Control Valve). DIGGA Anchor drives were developed specifically for the application of installing Screw Piers (Anchors) They are not just a gearbox fitted with a hydraulic motor. Digga Anchor Drive Systems include patented technology to ensure:

- Protection against Pile Kick (flick) back
- Consistent performance and torque delivery throughout your working day

Anchor drives are sold for torque application and can be fitted to many different types of machines. Many motor options are available along with custom drive solutions to suit clients individual needs. Complete services are available to support your anchor drive needs including:

- Torque reference charts
- Speed charts
- Torque measuring equipment
- Anchor alignment equipment
- Specialized piling hitches/cradles

To ensure a thorough analysis of client requirements are met please contact your Digga representative to assist you with this process.

ANCHOR DRIVES - REFERENCE CHART

QUICK REFERENCE CHART			MOTOR OPTIONS		
MODELS	MACHINE	TORQUE RANGE	SINGLE SPEED EATON	TWO SPEED EATON	RADIAL PISTON
	Tons	ft / lbs			
MM Drives	up to 3.5	10,000	Yes	-	-
Premium Drives	4-30	5,000 - 30,000	Yes	Yes	-
Supa Drives	15-30	30,000 - 70,000	-	-	Yes
Mega Drives	20 - 40	80,000 - 150,000	-	-	Yes
Ultra Drives	30 - 50	140,000 - 230,000	-	-	Yes
Xtreme Drives	45- 80	190,000 - 360,000	-	-	Yes

ANCHOR DRIVES INCLUDE HOOD PIN, PRV, ECV.
HOSES, QUICK DISCONNECTS, AND LINKAGE BLOCK SOLD SEPARATELY

HANDHELD ANCHOR DRIVES

GEARBOX & HYDRAULIC MOTOR ONLY, NO MOUNTINGS, POWER PACK OR HOSES SUPPLIED

ORDER CODE	MAX TORQUE	DESCRIPTION	PRV	ECV	CASE DRAIN REQ	MAX PRESSURE	MAX HP	REC FLOW	OUTPUT SHAFT	LIST PRICE
HH-6K	6528	SINGLE SPEED	INCL	N/A	NO	2100 PSI	20	15GPM	2" HEX	\$3,045
MM-10K	10,478	SINGLE SPEED	N/A	N/A	NO	3000 PSI	33	18GPM	2.5" HEX	\$3,995
HA-001000	-	HOSE & FOOT PEDAL KIT				-				\$1975

MINI LOADER AND EXCAVATORS UP TO 3.5T

HOSES, QUICK DISCONNECTS, AND LINKAGE BLOCK SOLD SEPARATELY

ORDER CODE	MAX TORQUE	DESCRIPTION	PRV	ECV	CASE DRAIN REQ	MAX PRESSURE	MAX HP	REC FLOW	OUTPUT SHAFT	LIST PRICE
MM-10K-11-HO	10,478	SINGLE SPEED - STEEL	INCL	N/A	NO	3000 PSI	33	18GPM	2.5" HEX	\$4,570

4-WAY SWING MODELS FRAMES AND MOUNTS SOLD SEPARATELY (EXCEPT WHERE NOTED)

ORDER CODE	MAX TORQUE	DESCRIPTION	PRV	ECV	CASE DRAIN REQ	MAX PRESSURE	MAX HP	REC FLOW	OUTPUT SHAFT	LIST PRICE
MM-10K-11-EM	10,478	SINGLE SPEED - STEEL	INCL	N/A	NO	3000 PSI	33	18GPM	2.5" HEX	\$5,200
MM-10K-11-ML	10,478	SINGLE SPEED - STEEL (FRAME INCLUDED)	INCL	N/A	NO	3000 PSI	33	18GPM	2.5" HEX	\$5,200
MM-10K-11-FR	10,478	SINGLE SPEED - STEEL	INCL	N/A	NO	3000 PSI	33	18GPM	2.5" HEX	\$5,200

ANCHOR DRIVES - SINGLE SPEED

5,000 - 30,000 lbs/ft

PURCHASE HOSES AND MOUNT SEPARATELY

SINGLE SPEED ANCHOR DRIVE - NO ECV (SWOOSH) >>

SUITABLE FOR INSTALLING ANCHORS THAT DO NOT EXCEED 10FT IN LENGTH. ECV (SWOOSH) IS RECOMMENDED FOR ALL ANCHOR INSTALLATION OF PIERS OVER 12,000 FT LBS AND 10FT IN LENGTH.

POWERED BY
EATON

3000 PSI RATED MACHINES - SINGLE SPEED DRIVES

ORDER CODE	MAX TORQUE	DESCRIPTION	PRV	CASE DRAIN REQ	MAX PRESSURE	MAX HP	REC FLOW	OUTPUT SHAFT	LIST PRICE
7DLS	7,166	LOW PRESSURE SINGLE SPEED	INCL	NO	3000 PSI @ 27GPM	55	35GPM	2.5" HEX	\$4,105
9DLS	9,893	LOW PRESSURE SINGLE SPEED	INCL	NO	3000 PSI @ 29GPM	60	48GPM	2.5" HEX	\$5,228
12DLS	12,445	LOW PRESSURE SINGLE SPEED	INCL	NO	3000 PSI @ 29GPM	60	48GPM	2.5" HEX	\$5,254

SINGLE SPEED ANCHOR DRIVE - INCLUDES ECV (SWOOSH) >>

3500 PSI RATED MACHINES - SINGLE SPEED DRIVES

ORDER CODE	MAX TORQUE	DESCRIPTION	PRV	CASE DRAIN REQ	MAX PRESSURE	MAX HP	MAX FLOW	OUTPUT SHAFT	LIST PRICE
5ADS	4,553	SINGLE SPEED	INCL	NO	3500 PSI @ 27GPM	55	55GPM @ 1700PSI	2.5" HEX	\$5,180
6ADS	5,728	SINGLE SPEED	INCL	NO	3500 PSI @ 27GPM	55	55GPM @ 1700PSI	2.5" HEX	\$5,205
7ADS	7,189	SINGLE SPEED	INCL	NO	3500 PSI @ 27GPM	55	55GPM @ 1700PSI	2.5" HEX	\$5,365
9ADS	9,112	SINGLE SPEED	INCL	NO	3500 PSI @ 29GPM	80	55GPM @ 1800PSI	2.5" HEX	\$6,488
12ADS	11,542	SINGLE SPEED	INCL	NO	3500 PSI @ 29GPM	80	55GPM @ 1800PSI	2.5" HEX	\$6,514
13ADS	12,808	SINGLE SPEED	INCL	NO	3500 PSI @ 33GPM	80	61GPM @ 1800PSI	3" HEX	\$8,198
16ADS	16,111	SINGLE SPEED	INCL	NO	3500 PSI @ 33GPM	80	61GPM @ 1800PSI	3" HEX	\$8,234
20ADS	20,514	SINGLE SPEED	INCL	NO	3500 PSI @ 33GPM	80	61GPM @ 1800PSI	100MM SQ	\$10,465
25ADS	24,514	SINGLE SPEED	INCL	NO	3500 PSI @ 33GPM	80	61GPM @ 1800PSI	100MM SQ	\$10,490
30ADS	30,771	SINGLE SPEED	INCL	NO	3500 PSI @ 33GPM	80	61GPM @ 1800PSI	100MM SQ	\$10,514

3000 PSI RATED MACHINES - SINGLE SPEED DRIVES

ORDER CODE	MAX TORQUE	DESCRIPTION	PRV	CASE DRAIN REQ	MAX PRESSURE	MAX HP	REC FLOW	OUTPUT SHAFT	LIST PRICE
7ALS	7,166	LOW PRESSURE SINGLE SPEED	INCL	NO	3000 PSI @ 27GPM	55	35GPM	2.5" HEX	\$5,365
9ALS	9,893	LOW PRESSURE SINGLE SPEED	INCL	NO	3000 PSI @ 29GPM	60	48GPM	2.5" HEX	\$6,488
12ALS	12,445	LOW PRESSURE SINGLE SPEED	INCL	NO	3000 PSI @ 29GPM	60	48GPM	2.5" HEX	\$6,514
13ALS	13,810	LOW PRESSURE SINGLE SPEED	INCL	NO	3000 PSI @ 33GPM	67	53GPM	3" HEX	\$8,198
16ALS	17,334	LOW PRESSURE SINGLE SPEED	INCL	NO	3000 PSI @ 33GPM	67	53GPM	3" HEX	\$8,234
20ALS	21,012	LOW PRESSURE SINGLE SPEED	INCL	NO	3000 PSI @ 39GPM	67	53GPM	100MM SQ	\$10,465
25ALS	26,375	LOW PRESSURE SINGLE SPEED	INCL	NO	3000 PSI @ 39GPM	67	53GPM	100MM SQ	\$10,490

ANCHOR DRIVES - TWO SPEED

5,000 - 30,000 lbs/ft

ALL 2 SPEED DRIVES COME FITTED WITH 10FT ELECTRICAL CONNECTION, PURCHASE 2 SPEED CONTROLLER KIT, HOSES AND MOUNT SEPARATELY

TWO SPEED ANCHOR DRIVE - NO ECV (SWOOSH) >>

3000 PSI RATED MACHINES - TWO SPEED ANCHOR DRIVES

ORDER CODE	MAX TORQUE	DESCRIPTION	PRV	CASE DRAIN REQ	MAX PRESSURE	MAX HP	REC FLOW	OUTPUT SHAFT	LIST PRICE
7DLT-11	7,333 / 4,849	LOW PRESSURE TWO SPEED	INCL	YES	3000 PSI @ 27GPM	55	35GPM	2.5" HEX	6,905
9DLT-11	10,310 / 6,800	LOW PRESSURE TWO SPEED	INCL	YES	3000 PSI @ 29GPM	55	35GPM	2.5" HEX	8,028
12DLT-11	12,705 / 8,383	LOW PRESSURE TWO SPEED	INCL	YES	3000 PSI @ 29GPM	60	48GPM	2.5" HEX	8,054

TWO SPEED ANCHOR DRIVE - INCLUDES ECV (SWOOSH) >>

3500 PSI RATED MACHINES - TWO SPEED DRIVES

ORDER CODE	MAX TORQUE	DESCRIPTION	PRV	ECV	CASE DRAIN REQ	MAX PRESSURE	MAX HP	MAX FLOW	OUTPUT SHAFT	LIST PRICE
7ADT-11	7,300 / 4,800	TWO SPEED	INCL	INCL	YES	3500 PSI @ 27GPM	55	35GPM	2.5" HEX	\$8,165
12ADT-11	12,028 / 7,934	TWO SPEED	INCL	INCL	YES	3500 PSI @ 29GPM	60	48GPM	2.5" HEX	\$9,314
13ADT-13	13,347 / 8,804	TWO SPEED	INCL	INCL	YES	3500 PSI @ 33GPM	67	53GPM	3" HEX	\$10,998
16ADT-13	16,448 / 10,853	TWO SPEED	INCL	INCL	YES	3500 PSI @ 33GPM	67	53GPM	3" HEX	\$11,034
20ADT-7	20,309 / 13,396	TWO SPEED	INCL	INCL	YES	3500 PSI @ 39GPM	80	53GPM	100MM SQ	\$13,265
25ADT-7	25,027 / 16,514	TWO SPEED	INCL	INCL	YES	3500 PSI @ 39GPM	80	53GPM	100MM SQ	\$13,290
30ADT-7	31,489 / 20,822	TWO SPEED	INCL	INCL	YES	3500 PSI @ 39GPM	80	53GPM	100MM SQ	\$13,314

3000 PSI RATED MACHINES - TWO SPEED ANCHOR DRIVES

ORDER CODE	MAX TORQUE	DESCRIPTION	PRV	ECV	CASE DRAIN REQ	MAX PRESSURE	MAX HP	REC FLOW	OUTPUT SHAFT	LIST PRICE
7ALT-11	7,333 / 4,849	LOW PRESSURE TWO SPEED	INCL	INCL	YES	3000 PSI @ 27GPM	55	35GPM	2.5" HEX	\$8,165
9ALT-11	10,310 / 6,800	LOW PRESSURE TWO SPEED	INCL	INCL	YES	3000 PSI @ 29GPM	55	35GPM	2.5" HEX	\$9,288
12ALT-11	12,705 / 8,383	LOW PRESSURE TWO SPEED	INCL	INCL	YES	3000 PSI @ 29GPM	60	48GPM	2.5" HEX	\$9,314
13ALT-13	13,347 / 8,804	LOW PRESSURE TWO SPEED	INCL	INCL	YES	3000 PSI @ 33GPM	67	53GPM	3" HEX	\$10,998
16ALT-13	17,739 / 11,729	LOW PRESSURE TWO SPEED	INCL	INCL	YES	3000 PSI @ 33GPM	67	53GPM	3" HEX	\$11,034
20ALT-7	21,452 / 14,155	LOW PRESSURE TWO SPEED	INCL	INCL	YES	3000 PSI @ 39GPM	80	53GPM	100MM SQ	\$13,265
25ALT-7	26,991 / 17,847	LOW PRESSURE TWO SPEED	INCL	INCL	YES	3000 PSI @ 39GPM	80	53GPM	100MM SQ	\$13,290

2 SPEED CONTROLLER >> NOT INCLUDED IN PRICE OF DRIVE - ORDER SEPARATELY

NOTE - ALL 2 SPEED DRIVES COME WITH A 10FT HARNESS WITH 2 PIN PLUG

PART NUMBER	DESCRIPTION	LIST PRICE
DM-000034	PLUG N PLAY KIT INCLUDES ROCKER SWITCH, CIGARRETE LIGHTER POWER LEAD & 20' HARNESS	\$390
DM-000038	PLUG N PLAY KIT INCLUDES ROCKER SWITCH, CIGARRETE LIGHTER POWER LEAD & 40' HARNESS	\$459
DM-000039	PLUG N PLAY KIT INCLUDES ROCKER SWITCH, CIGARRETE LIGHTER POWER LEAD & 50' HARNESS	\$496
OPTIONAL EXTRAS		
DM-000026	JOYSTICK MOUNTED TOGGLE SWITCH	\$77
DM-000030	FLOOR MOUNTED SWITCH	\$74
DM-000022	2 PIN, 15M(50FT) BOOM EXTENSION HARNESS	\$211
DM-000023	2 PIN, 12M (40FT) BOOM EXTENSION HARNESS	\$182
DM-000024	2 PIN, 6M(20FT) BOOM EXTENSION HARNESS	\$124
DM-000025	2 PIN, 3M(10FT) BOOM EXTENSION HARNESS	\$92

LARGE ANCHOR DRIVES - TWO SPEED

30,000 - 360,000 lbs/ft

SD, MD, UD & XD DRIVES INCLUDE 10FT ELECTRICAL CONNECTION, 2 SPEED CONTROL BOX, CIGARETTE LIGHTER POWER LEAD & 50FT BOOM EXTENSION HARNESS. ORDER HOSES, MACHINE MOUNTS SEPARATELY

30,000 - 70,000 ft/lb - SUPA DRIVES

MAXIMUM FLOW - 100GPM / MAXIMUM POWER - 200HP

ORDER CODE	MAX TORQUE	DESCRIPTION	PRV	ECV	CASE DRAIN REQ	MAX PRESSURE @100GPM	MOTOR	OUTPUT SHAFT	LIST PRICE
SD-45-T3	32,900	TWO SPEED	INCL	INCL	YES	3500 PSI	RADIAL PISTON	100MM SQ	\$29,850
SD-50-T3	38,500	TWO SPEED	INCL	INCL	YES	3500 PSI	RADIAL PISTON	100MM SQ	\$29,850
SD-70-T3	50,400	TWO SPEED	INCL	INCL	YES	3500 PSI	RADIAL PISTON	100MM SQ	\$29,850
SD-80-T3	60,800	TWO SPEED	INCL	INCL	YES	3500 PSI	RADIAL PISTON	100MM SQ	\$29,850
SD-95-T3	67,600	TWO SPEED	INCL	INCL	YES	3500 PSI	RADIAL PISTON	100MM SQ	\$29,850
Z-003904	HEAVY DUTY SHIPPING & STORAGE CRADLE								\$2,004.81
HI-000046	130MM LINKAGE								\$1,401.70

80,000 - 150,000 ft/lb - MEGA DRIVES

MAXIMUM FLOW - 100GPM / MAXIMUM POWER - 200HP

ORDER CODE	MAX TORQUE	DESCRIPTION	PRV	ECV	CASE DRAIN REQ	MAX PRESSURE @100GPM	MOTOR	OUTPUT SHAFT	LIST PRICE
MD-110-T3	84,800	TWO SPEED	INCL	INCL	YES	3500 PSI	RADIAL PISTON	130MM SQ	\$43,000
MD-160-T3	125,600	TWO SPEED	INCL	INCL	YES	3500 PSI	RADIAL PISTON	130MM SQ	\$54,000
MD-190-T3	147,300	TWO SPEED	INCL	INCL	YES	3500 PSI	RADIAL PISTON	130MM SQ	\$64,000
Z-003244	HEAVY DUTY SHIPPING & STORAGE CRADLE								\$2,347.80
HI-000318	200MM SQ LINKAGE								\$3,415
HO-000873	SPARE EAR & PIN KITS								\$1,765

140,000 - 230,000 ft/lb - ULTRA DRIVES

MAXIMUM FLOW - 100GPM / MAXIMUM POWER - 200HP

ORDER CODE	MAX TORQUE	DESCRIPTION	PRV	ECV	CASE DRAIN REQ	MAX PRESSURE @100GPM	MOTOR	OUTPUT SHAFT	LIST PRICE
UD-190-T3	138,500	TWO SPEED	INCL	INCL	YES	3500 PSI	RADIAL PISTON	150MM SQ	\$87,570
UD-220-T3	154,000	TWO SPEED	INCL	INCL	YES	3500 PSI	RADIAL PISTON	150MM SQ	\$87,570
UD-250-T3	180,600	TWO SPEED	INCL	INCL	YES	3500 PSI	RADIAL PISTON	150MM SQ	\$87,570
UD-300-T3	226,500	TWO SPEED	INCL	INCL	YES	3500 PSI	RADIAL PISTON	150MM SQ	\$87,570
Z-003027	HEAVY DUTY SHIPPING & STORAGE CRADLE								\$2,907.80
HI-000318	200MM SQ LINKAGE								\$3,415
HO-000873	SPARE EAR & PIN KITS								\$1,765

DIGGA ATTACHMENT RANGE 2019

190,000 - 360,000 ft/lb - XTREME DRIVES

MAXIMUM FLOW - 100GPM / MAXIMUM POWER - 200HP

ORDER CODE	MAX TORQUE	DESCRIPTION	PRV	ECV	CASE DRAIN REQ	MAX PRESSURE @100GPM	MOTOR	OUTPUT SHAFT	LIST PRICE
XD-270-T3	192,700	TWO SPEED	INCL	INCL	YES	3500 PSI	RADIAL PISTON	200MM SQ	\$125,306.25
XD-300-T3	226,000	TWO SPEED	INCL	INCL	YES	3500 PSI	RADIAL PISTON	200MM SQ	\$125,306.25
XD-410-T3	295,700	TWO SPEED	INCL	INCL	YES	3500 PSI	RADIAL PISTON	200MM SQ	\$125,306.25
XD-500-T3	356,400	TWO SPEED	INCL	INCL	YES	3500 PSI	RADIAL PISTON	200MM SQ	\$125,306.25
Z-003169	HEAVY DUTY SHIPPING & STORAGE CRADLE								\$3,210.30
HI-000710	300MM SQ LINKAGE								\$4,087
HO-000863	SPARE EAR AND PIN KIT								\$3,210.30

MACHINE MOUNTS

ANCHOR DRIVES SOLD ON THEIR OWN - ORDER ACCESSORIES SEPARATELY

EXCAVATOR MOUNTS

LOOSE PIN - MACHINES WITH NO PIN GRAB

LOOSE PIN		
ORDER CODE	PIN SIZE	LIST PRICE
PL303	45-50MM PIN	\$550
PL304	55MM TO 70MM	\$1,240
PL305	75MM TO 100MM	\$1,945
PL305-SD	75MM TO 100MM TO SUIT SD	\$2,495
PL305-MD	TO SUIT MD	\$2,995
PL305-UD	TO SUIT UD	\$3,295

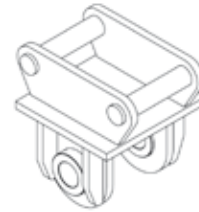

MOUNTING OPTIONS AVAILABLE FOR BOBCAT X-CHANGE, JOHN DEERE, KUBOTA, WAIN ROY AND TAG COUPLERS FOR MINI EXCAVATORS.

ASK FOR PRICING

LINKAGES

ORDER CODE	DESCRIPTION	LIST PRICE
HI-000128K	75MM LINKAGE TO SUIT SKID STEERS	\$90
HI-000393K	75MM LINKAGE TO SUIT EXCAVATORS	\$90
HI-000129K	100MM LINKAGE	\$510

MOUNT BRACKET & LINKAGE SOLD SEPARATELY



SKID STEER FIXED CENTER MOUNT

ORDER CODE	DESCRIPTION	LIST PRICE
FR-001287	CENTRE MOUNT MULTIFIT FRAME TO SUIT 2DSS TO 4DSS DRIVES	\$500
FR-001286	TO SUIT 4DDS TO 7DDS DRIVES	\$560

INCLUDES LINKAGE AND PIN - MORE FRAMES AVAILABLE UPON REQUEST

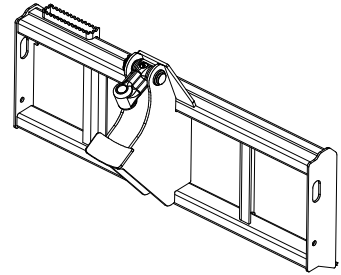

SKID STEER SIDE SHIFT MOUNT (MANUAL)

ORDER CODE	DESCRIPTION	LIST PRICE
FR-001247	MULTIFIT HD SKID STEER FRAME ONLY	\$415
HI-000353	CRADLE TO SUIT 2DSS TO 4DSS	\$260
HI-000408	CRADLE TO SUIT 4DDS TO 7DDS	\$397
HI-000409	CRADLE TO SUIT 9DDS - 16DDS	\$640

ORDER SLIDE CRADLE SEPARATELY, CRADLE INCLUDES LINKAGE & PIN

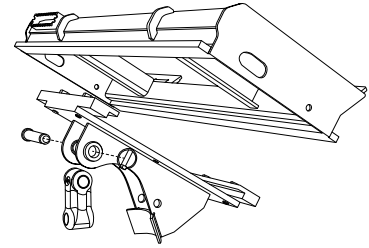

SKID STEER TELESCOPIC PILING & DRILLING EXTENTION - TPE

ORDER CODE	PIN SIZE	LIST PRICE
TPE-000050	TO SUIT DRIVES 5, 6, 7	\$2,595
TPE-000039	TO SUIT DRIVES 9, 12, 13, 16	\$2,795

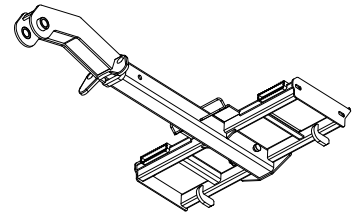

BACKHOE MOUNTS

ORDER CODE	DESCRIPTION	LIST PRICE
HI-001175	BACKHOE CRADLE SUIT DRIVES 5,6,7	\$420
HI-001174	BACKHOE CRADLE SUIT DRIVES 9, 12, 13, 16	\$775

BACKHOE CRADLE KITS INCLUDE LINKAGE AND PIN - ORDER MACHINE MOUNT SEPARATELY

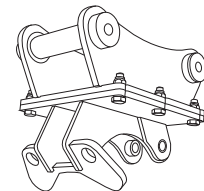

PILING DRIVE RYNO HITCH

ORDER CODE	PIN SIZE	LIST PRICE
HI-000678	TO SUIT DRIVES 9 TO 16	\$1,350
HI-000847	TO SUIT DRIVES 20 TO 30	\$1,850
HI-001098	TO SUIT SD DRIVES	\$2,995
HI-001078	TO SUIT MD DRIVES	\$5,495
HI-001349	TO SUIT UD DRIVES	\$5,995
HI-001065	TO SUIT XD DRIVES	\$8,995

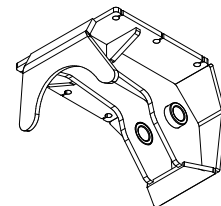

HOSE KITS

ORDER CODE	DESCRIPTION	LIST PRICE
HS-002479	3/4" - 87" OAL - 1/2" FF Quick Disconnects-HOSE SHEATHING	\$305
HS-002480	3/4" - 87" OAL - 3/4" FF Quick Disconnects-HOSE SHEATHING	\$325
HS-002391	3/4" - 6FT OAL - 1/2" FF Quick Disconnects	\$305
HS-002392	3/4" - 6FT OAL - 3/4" FF Quick Disconnects	\$325
HS-002393	3/4" - 8FT OAL - 1/2" FF Quick Disconnects	\$335
HS-002394	3/4" - 8FT OAL - 3/4" FF Quick Disconnects	\$355
HS-002395	3/4" - 10FT OAL - 1/2" FF Quick Disconnects	\$365
HS-002396	3/4" - 10FT OAL - 3/4" FF Quick Disconnects	\$385
HS-002397	3/4" - 12FT OAL - 1/2" FF Quick Disconnects	\$395
HS-002398	3/4" - 12FT OAL - 3/4" FF Quick Disconnects	\$415
HS-002469	FOR TPE - 1/2" - 14FT OAL - 1/2" FF Quick Disconnects	\$425
HS-002470	FOR TPE - 1/2" - 14FT OAL - 3/4" FF Quick Disconnects	\$445

CASE DRAIN KITS

ORDER CODE	DESCRIPTION	LIST PRICE
HIGH FLOW DRIVES - 6K BELL MOTORS		
HS-002519	87" Long - 3/8" Male FFC	\$85
HS-002520	87" Long - 3/8" Female FFC	\$95
HIGH FLOW TRENCHERS		
HS-002517	87" Long - 3/8" Male FFC	\$85
HS-002518	87" Long - 3/8" Female FFC	\$95

ANCHOR DRIVE ACCESSORIES

DIGGALIGN (INCLINOMETER) - FACTORY FITTED

PART NUMBER	DESCRIPTION	DEFINITION	LIST PRICE
DT-000002	DIGGALIGN KIT- WITH 15M EXT HARNESS	STANDARD	\$2,590
DT-000033	DIGGALIGN KIT- WITH 12M EXT HARNESS	STANDARD	\$2,569
DT-000034	DIGGALIGN KIT- WITH 6M EXT HARNESS	STANDARD	\$2,503
DT-000035	DIGGALIGN KIT- WITH 3M EXT HARNESS	STANDARD	\$2,462
DT-000001	DIGGALIGN KIT- WITH 15M EXT HARNESS	HIGH	\$2,590
DT-000030	DIGGALIGN KIT- WITH 12M EXT HARNESS	HIGH	\$2,569
DT-000031	DIGGALIGN KIT- WITH 6M EXT HARNESS	HIGH	\$2,503
DT-000032	DIGGALIGN KIT- WITH 3M EXT HARNESS	HIGH	\$2,462

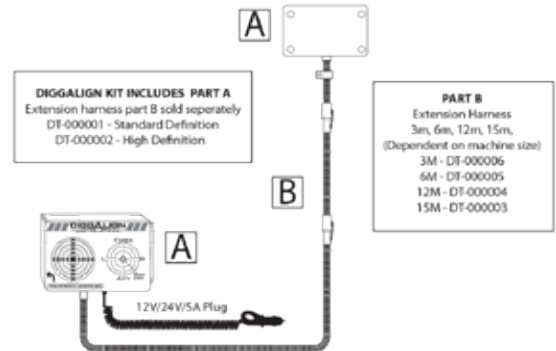

FACTORY FITTED AT TIME OF ORDER
STANDARD DEFINITION SUITABLE FOR PILES / AUGERS UNDER 13FT LONG
HIGH DEFINITION REQUIRED FOR PILES / AUGERS OVER 13FT LONG

DIGGALIGN (INCLINOMETER) - RETRO FIT

PART NUMBER	DESCRIPTION	DEFINITION	LIST PRICE
DT-000048	DIGGALIGN KIT- WITH 15M EXT HARNESS	STANDARD	\$2,590
DT-000049	DIGGALIGN KIT- WITH 12M EXT HARNESS	STANDARD	\$2,561
DT-000050	DIGGALIGN KIT- WITH 6M EXT HARNESS	STANDARD	\$2,474
DT-000051	DIGGALIGN KIT- WITH 3M EXT HARNESS	STANDARD	\$2,420
DT-000052	DIGGALIGN KIT- WITH 15M EXT HARNESS	HIGH	\$2,590
DT-000053	DIGGALIGN KIT- WITH 12M EXT HARNESS	HIGH	\$2,569
DT-000054	DIGGALIGN KIT- WITH 6M EXT HARNESS	HIGH	\$2,503
DT-000055	DIGGALIGN KIT- WITH 3M EXT HARNESS	HIGH	\$2,462

FITTED BY OPERATOR
STANDARD DEFINITION SUITABLE FOR PILES / AUGERS UNDER 13FT LONG
HIGH DEFINITION REQUIRED FOR PILES / AUGERS OVER 13FT LONG

ECV (SWOOSH) - Pile Anti Kick-Back Valve

ORDER CODE	DESCRIPTION	LIST PRICE
VB-000344	ANTI KICK-BACK VALVE	\$1,631

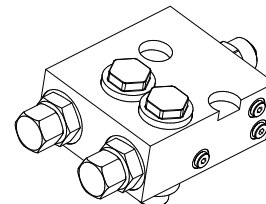

TORQUE MEASUREMENT SYSTEMS

TORQUE PIN - DIGGA TORQUE LOGIC (STRAIN GAUGE)

ORDER CODE	DESCRIPTION	LIST PRICE
DTL-001442	45MM HARDWIRED TORQUE PIN WITH 30' CABLE	\$6,840
DTL-001443	75MM HARDWIRED TORQUE PIN WITH 40' CABLE	\$10,170
DTL-001444	100MM HARDWIRED TORQUE PIN WITH 75' CABLE	\$18,995

KIT INCLUDES PIN, MAIN & EXTENSION CABLES (TOTAL LENGTH AS PER ABOVE) 7" DISPLAY SCREEN, MOUNT AND POWER SUPPLY.

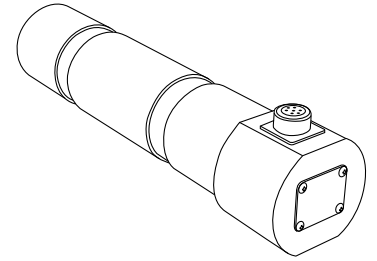

TORQUE HUB

ORDER CODE	DESCRIPTION	LIST PRICE
DTL-001550	2" HEX WIRELESS TORQUE MEASURING HUB	\$6,840
DTL-001551	2.5" HEX WIRELESS TORQUE MEASURING HUB	\$6,840
DTL-001552	2.625" HEX WIRELESS TORQUE MEASURING HUB	\$6,840
DTL-001553	3" HEX WIRELESS TORQUE MEASURING HUB	\$6,840
DTL-001576	100MM SQUARE WIRELESS TORQUE MEASURING HUB	TBA

KIT INCLUDES TORQUE HUB, 7" DISPLAY SCREEN, PROTECTIVE CASE, MOUNT, SPARE BATTERY AND POWER SUPPLY.

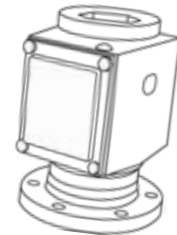

PRESSURE DIFFERENTIAL KIT - ELECTRONIC

ORDER CODE	DESCRIPTION	LIST PRICE
EH-000024	PRESSURE DIFFERENTIAL GAUGE WITH 50FT BOOM HARNESS	\$2,350
EH-000023	PRESSURE DIFFERENTIAL GAUGE WITH 40FT BOOM HARNESS	\$2,305
EH-000022	PRESSURE DIFFERENTIAL GAUGE WITH 20FT BOOM HARNESS	\$2,295
EH-000021	PRESSURE DIFFERENTIAL GAUGE WITH 10FT BOOM HARNESS	\$2,255

KIT INCLUDES 2 TRANSDUCERS, BOOM HARNESS, INCAB DISPLAY, SHROUD COVER. AND CIGARETTE LIGHTER POWER LEAD.

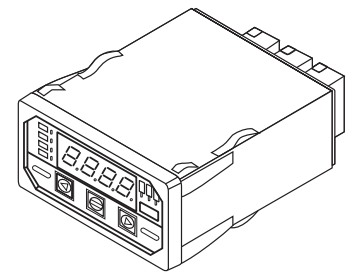

INLINE PRESSURE RELIEF VALVE - WITH GAUGES

ORDER CODE	DESCRIPTION	LIST PRICE
KIT-000047	INLINE PRESSURE RELIEF VALVE-WITH GAUGES	\$565

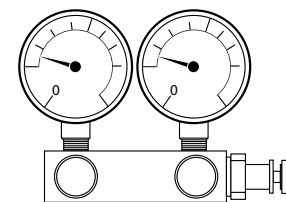

DIGGA PRODUCTS

A Digga Product is defined as products manufactured and or sold by Digga North America.

Important Information

Before selecting or using a Digga product it is important that all information concerning the product warranty, limitation of liability and responsibility of the customer be reviewed. This information is located below. Please direct any questions regarding this information to your Digga Representative

Disclaimer

This catalogue provides product options for further investigation by customers having technical expertise with respect to the use of such products. It is the responsibility of the customer to thoroughly analyse all aspects of the customer's application and to review the information concerning the product in the current product catalogue. Due to the diversity of possible applications, the customer is solely responsible for making the final selection of the product(s) to be used and to assure that all performance, safety and warning requirements of the application are met.

While Digga has made all reasonable efforts to present accurate information in this catalogue it shall not be held responsible for any incorrect information which may result from unintentional oversight. Due to continuous product improvement, the product specifications as stated in this catalogue are subject to change by Digga at any time without notice. The customer should consult a sales representative of Digga for detailed information and to determine any changes in the information in this catalogue.

Improper selection or improper use of the Digga products supplied herein can result in death, personal injury and/or property damage. Digga North America sole responsibility with respect to its products is set forth in the warranty/limitation of liability policy stated herein.

WARRANTY

MDS, DS & DD Drilling Drive Units

Used for Drilling Application

5yr Gearbox & 3yr Motor

AD & AL Anchor Drive Units (fitted with ECV)

Used for Anchor Application 5AD/L – 30AD/L

3yr Gearbox & 2yr Motor

DS, DD & DL Drilling Drive Units (without ECV)

Used for anchoring up to 12,000ft lbs

2yr Gearbox & 1yr motor

DD & DL Drilling Drive Units (without ECV)

Used for anchoring over 12,000ft lbs

No Warranty

SD, MD, UD & XD Drives

For all applications

1yr Gearbox & 1yr Motor

Hand Helds

1yr Gearbox & 1yr Motor

Bigfoot Trenchers

3yr Gearbox & 2yr Motor

All Other Attachments

12 months

© Copyright Digga – All rights reserved.

This catalogue and/or any portion thereof protected by this copyright herein may not be reproduced in any form whatsoever without the written permission of the Copyright owner

LIMITED WARRANTY

Digga products are sold subject to a limited warranty and a limitation of remedies policy, both of which constitute part of any and all agreements to purchase Digga products. Digga makes no other warranties or promises other than those specifically noted in its written policies, and no Digga employee or agent has the power to alter those policies

All new products are warranted to be free from defects in material and/or workmanship for one (1) year. Under no circumstances will it cover any merchandise or components thereof, which, in the opinion of the company, have been subject to misuse, unauthorized modifications, alterations, accidents, or if repairs have been made with parts other than those obtainable through Digga.

Warranty period will begin on the date of invoice, or 6 months after invoice date if no product registration is received. In the event of a defect within the warranty period (excluding: Cable, ground engaging parts such as sprockets, digging chain, bearings, teeth, blade cutting edges, pilot bits, auger teeth, auger heads, and broom brushes) and after examination, it is determined failure was due to defective material and/or workmanship, part(s) will be repaired or replaced. DIGGA may request defective part(s) be returned to them for inspection at their place or business or sent to a specified locations.

Any claims under this warranty must be made within thirty (30) days from date of repair, and all repairs must be made within 30 days from date of failure. All claims not made in writing and received within these time periods specified above shall be denied.

LIMITATIONS ON RESPONSIBILITY

THIS WARRANTY IS IN LIEU OF ALL OTHER WARRANTIES, EXPRESSED OR IMPLIED, AND THERE ARE NO WARRANTIES OF MERCHANTABILITY OR OF FITNESS FOR A PARTICULAR PURPOSE. IN NO EVENT SHALL DIGGA BE LIABLE FOR CONSEQUENTIAL OR SPECIAL DAMAGE.

DIGGA LIABILITY FOR ANY AND ALL LOSSES AND DAMAGES TO BUYER, RESULTING FROM ANY CAUSE WHATSOEVER, INCLUDING NEGLIGENCE, IRRESPECTIVE OF WHETHER SUCH DEFECTS ARE DISCOVERABLE OR LATENT, SHALL IN NO EVENT EXCEED THE PURCHASE PRICE OF THE PARTICULAR PRODUCTS WITH RESPECT TO WHICH LOSSES OR DAMAGES ARE CLAIMED, OR, AT THE ELECTION OF DIGGA THE REPAIR OR REPLACEMENT OF DEFECTIVE OR DAMAGED PRODUCTS.

WARRANTY PROCEDURE

Upon notification of a problem/failure on a component, please advise the DIGGA Service Department as to the following:

- Serial number of the attachment
- Description of specific component failure
- Details of the Prime Mover including Machine Type, Model, system flows and pressure
- Comments pertaining to failure from end user

The warranty will be considered void if the product or any part of the product is modified or repaired in any way not expressly authorised by Digga, or if closed components are disassembled prior to return. If repair will require parts, you must refer to warranty consideration when ordering parts through the Customer Service Department.

Upon receipt of replacement parts or verbal approval from the Customer Service Department to proceed with warranty resolution, all defective parts must be retained for evaluation by Digga. Failure to retain defective parts will result in cancellation to any warranty consideration.

If a defective component is deemed necessary to be returned to Digga, a Goods Return Authorisation/credit (GRC) receiving number will be issued. All shipping documents should show this number.

If a defective component can be fixed at your location or in the field, please notify DIGGA for authorization prior to performing work. Send a picture of the defect to the DIGGA Service Department before proceeding with any other repairs.

Upon completion of the repairs, send all relevant documentation showing labor hours, material costs, and any other warranty costs as described in the DIGGA Warranty Policy.

Flat rate hours will be quoted by the DIGGA Service Department for any repair. If problems are encountered that were not addressed originally, DIGGA must be contacted to obtain authorization for additional labor hours. DIGGA will not be responsible for work performed without prior notification and authorisation.



DIGGA NORTH AMERICA

2325 INDUSTRIAL PARKWAY SW
DYERSVILLE, IA 52040
USA

PH: +1 563 875 7915
CELL: +1 563 845 9177
EMAIL: INFOUS@DIGGA.COM
WWW.DIGGAUSA.COM

DIGGA AUSTRALIA

4 OCTAL STREET
YATALA QLD 4207
AUSTRALIA

PH: +61 (0) 7 3807 3330
MOBILE: +61 (0) 418 343 241
EMAIL: INFO@DIGGA.COM
WWW.DIGGA.COM

DIGGA UK

UNIT 6, SMITHAM BRIDGE ROAD
HUNGERFORD TRADING ESTATE
HUNGERFORD, BERKSHIRE RG17 0QU
ENGLAND, UNITED KINGDOM

PH: +44 (0) 1264 351 365
MOBILE: +44 (0) 7739 754 161
EMAIL: INFOUK@DIGGA.COM
WWW.DIGGAEUROPE.COM